

- Self-contained packaged units with gas fired heating and electric cooling
  - Pre-wired and pre-charged with R410a refrigerant
  - Eliminates the need for outdoor condensers, electrical, refrigerant piping, and external venting
  - FPG units are compatible with Magic Pak, Comfort Pack and Condo Pack
- 
- Blower collar locking mechanism to improve seal between cooling chassis and cabinet
  - High efficiency ECM indoor blower motor with multiple speed taps for precise airflow selection
  - High efficiency ECM outdoor fan motor to improve system efficiency
  - Dual inlet indoor blower to lower fan rpm's, improve efficiency and reduce noise

# Features & Benefits

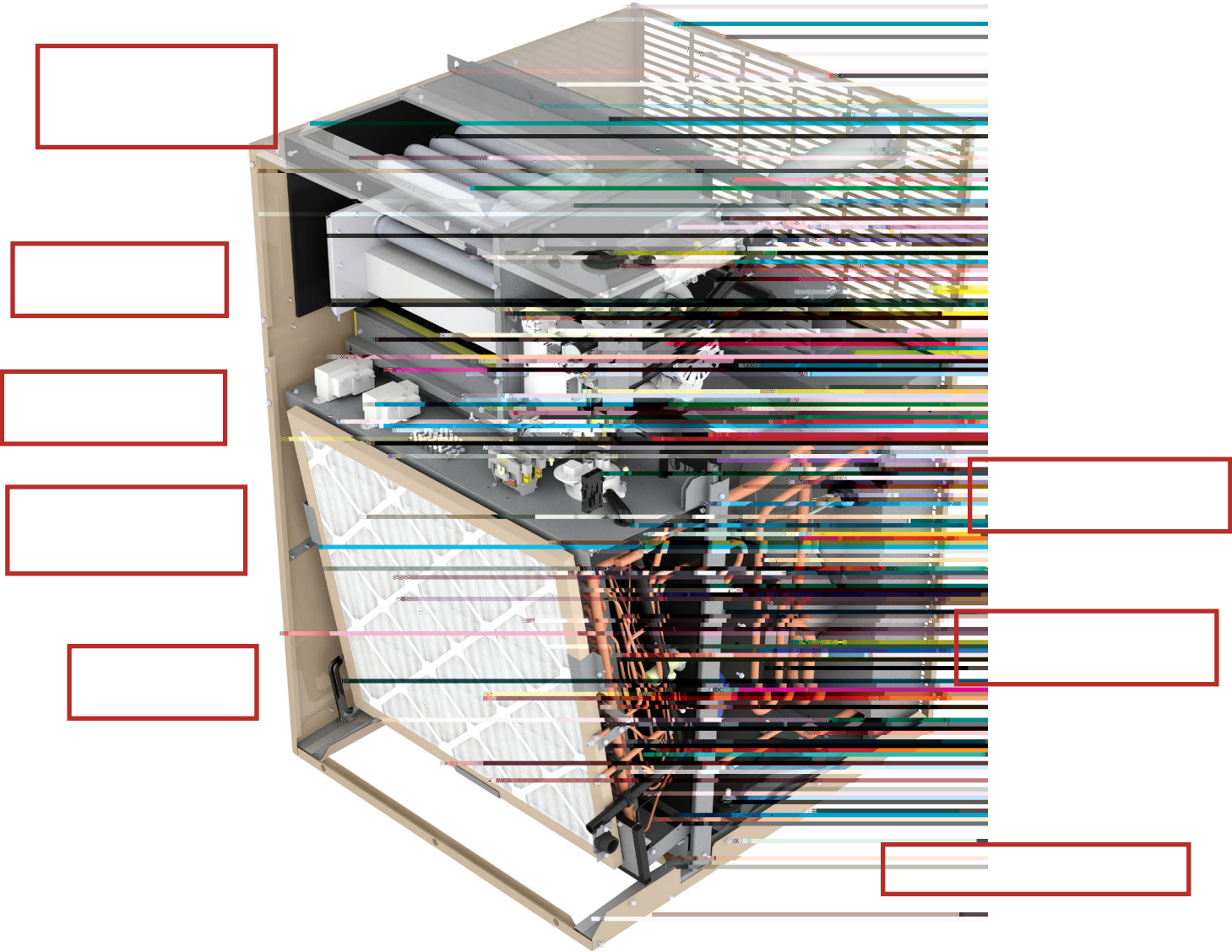



Continued

	Scroll (1)	Scroll (1)	Scroll (1)	Scroll (1)	Scroll (1)
	4.9 [2.21]	4.9 [2.21]	4.9 [2.21]	5.0 [2.27]	5.0 [2.27]
	35MFD/ 370V	35MFD/ 370V	35MFD/370V	30MFD/370V	30MFD/370V
	1/3 [.25]	1/3 [.25]	1/3 [.25]	1/3 [.25]	1/3 [.25]
	1/3 [.25]	1/2 [.37]	1/2 [.37]	1/2 [.37]	1/2 [.37]
	10 x 6 [25.4 x 15.24]				
	26.5 x 22.25 [67.3 x 56.5]				
	23.1 x 22.25 [58.7 x 56.5]				
	24 x 24 [60.96 x 60.96]				
	33000 [9.7]	44000 [12.9]	55000 [16.1]	44000 [12.9]	55000 [16.1]
	31350 [9.2]	41360 [12.1]	51150 [15]	41360 [12.1]	51150 [15]
	95	94	93	94	93
	3	4	5	4	5
<b>Orifice Size (Natural)</b>	.0635 [1.61]	.0635 [1.61]	.0635 [1.61]	.0635 [1.61]	.0635 [1.61]
	160 [71]	180 [82]	185 [85]	180 [82]	185 [85]
	.5 [125]				
	0.5 [1.27]				
	322 [146]	324 [147]	326 [148]	338 [153]	340 [154]
	349 [158]	351 [159]	353 [160]	365 [165]	367 [166]

	24" x 24"	300	400	500	600	700	800	900	1000
		0.008	0.017	0.027	0.036	0.046	0.055	0.065	0.074

## *Unit Dimensions*





							490	22,000	21,120	96	25-55
	12,000	10.0	11.7	0.75	450	-	650	33,000	31,350	95	30-60
							850	44,000	41,360	94	30-60
							490	22,000	21,120	96	25-55
	16,500	10.0	11.7	0.78	630	-	650	33,000	31,350	95	30-60
							850	44,000	41,360	94	30-60
							950	5,000	51,150	93	35-65
							650	33,000	31,350	95	30-60
	22,000	10.0	11.7	0.74	780	-	850	44,000	41,360	94	30-60
							950	55,000	51,150	93	35-65
							850	44,000	41,360	94	30-60
	26,000	9.0	11.7	0.74	920	620	950	55,000	51,150	93	35-65

\*S/T is not a rated value

All FPG\*\*N9030C models tested with dual stage scroll compressors







FIRST CO. P.O. BOX 270969 - DALLAS, TEXAS 75227  
PH. (214) 388-5751 | FAX (214) 388-2255  
[WWW.FIRSTCO.COM](http://WWW.FIRSTCO.COM)